

## VN-Box HT



Box fan with forward curved blades for high temperatures F400.

If you are looking for a fan with a specific working point, please don't hesitate to contact us by phone +31 (0)416 391999 or email [info@ventinet.nl](mailto:info@ventinet.nl) and we will select the right fan for you.

The fans are suitable to extract smoke and hot air and are certificated following EN 12101-3:2015 in class F400.

Sizes	250 up to 500 mm
Motor (standard)	Norm motor IP55, 400/3/50
Capacity	up to 35.000 m <sup>3</sup> /h
Pressure	up to 1.800 Pa
Control	Frequency converter
Casing	Steel galvanized
Extra	Suitable for high temperatures up to <b>200°C</b> continuously and <b>400°C</b> for 120 minutes (F400)  Different positions outlet possible
Accessories	Protection grid / Mounting feet / Flexible connections / Anti-vibration mounts / Filter section / Switches / Frequency converters

## 4 pole (1.500 rpm.) – 400/3/50

Model	RPM	Q max. (m <sup>3</sup> /h)	Pressure max. (Pa stat.)	Motor (kW)	In max. (A)
250/A	1800	5.700	750	2,20	4,90
250/B	1600	5.050	600	1,50	3,45
250/C	1400	4.300	450	1,10	2,64
250/D	1200	3.700	350	0,75	1,93
250/E	1000	3.150	250	0,37	1,11
300/A	1800	9.700	1080	5,50	11
300/B	1600	8.700	900	4,00	8,26
300/C	1400	7.400	690	3,00	6,47
300/D	1200	6.300	500	2,20	4,90
300/E	1000	5.300	350	1,10	2,64
350/A	1600	13.600	1160	11,0	21,3
350/B	1400	12.000	850	5,50	11
350/C	1200	10.100	640	4,00	8,26
350/D	1000	8.250	425	2,20	4,90
350/E	800	6.800	260	1,10	2,64
400/A	1400	18.200	1150	11,0	21,3
400/B	1200	16.000	810	7,50	1,46
400/C	1000	13.000	600	4,00	8,26
400/D	800	10.100	380	2,20	4,90
450/A	1400	25.500	1450	22,0	40,7
450/B	1200	22.000	1100	15,0	28,5
450/C	1000	18.000	780	7,50	14,6
450/D	800	14.500	510	4,00	8,26
450/E	600	11.000	300	1,50	3,45
500/A	1400	35.000	1800	30,0	55,0
500/B	1200	30.000	1300	22,0	40,7
500/C	1000	25.000	900	15,0	28,5
500/D	800	20.000	600	7,50	14,6
500/E	600	15.000	350	3,00	6,47

[Types and changes reserved]

## Indication dimensions VN-Box HT

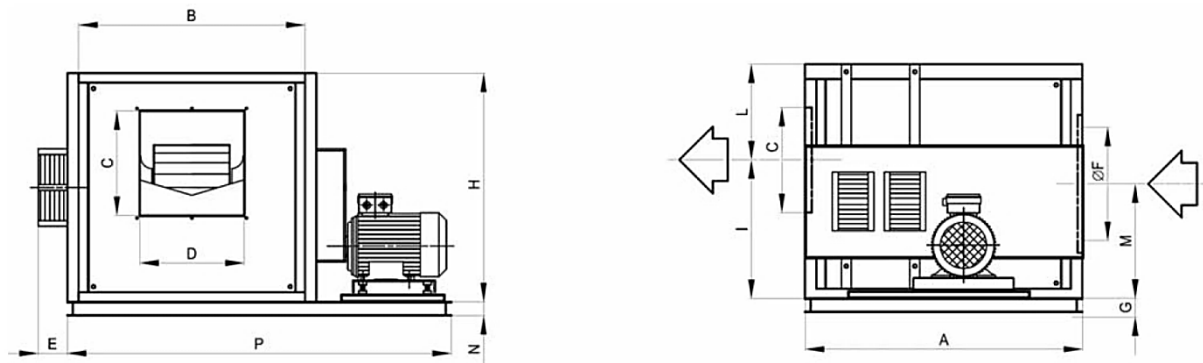

	A	B	H	C	D	E	$\phi F$	G	I	L	M	N	P	Qmax
250	650	600	600	300	300	158	405	100	370	230	300	-	-	350
300	730	700	680	350	350	173	500	100	425	255	340	-	-	410
350	860	800	750	400	400	173	610	100	470	280	375	80	1570	410
400	1030	900	840	450	450	173	650	100	535	305	420	100	1670	420
450	1200	1000	960	500	500	173	750	100	630	330	480	120	1750	420
500	1250	1200	1020	600	600	173	800	100	640	380	510	120	2150	420